

Dedicated Outdoor Air Systems

for high percentage and 100% outside air

Models RV and RVE

• Institutional • Commercial • Industrial

- Up to 18,000 cfm
- 3.0 in. wg External Static Pressure
- Packaged DX (5-70 tons), Chilled Water, Split DX Cooling with or without Remote Condenser
- Indirect Gas, Hot Water, Electric Heating
- Optional Energy Recovery
- Optional Return Air



Greenheck is 100% Dedicated to Outdoor Air Systems!

Models RV and RVE

- 2-inch double-wall with R13 foam insulation construction
- 800 to 18,000 cfm and up to 3 in. wg
- Ideal for 100% outdoor air, variable air volume, and single zone applications
- Direct drive, VFD driven, backward-inclined supply/exhaust fans
- Optional recirculation damper for 20-100% outside air and night setback operation
- Optional total energy wheel
- Optional horizontal duct configurations for side return and supply



Cooling

- 5 to 70 nominal tons of cooling
- Chilled water, packaged direct expansion, or split direct expansion with or without remote condenser
- Low sound condenser fans
- Optional inverter, digital or standard scroll compressor
- Optional modulating hot gas reheat for humidity control
- Optional electronically commutated (EC) motor on lead condenser fan

Heating

- Indirect gas-fired, electric, or hot water
- Up to 1,200 mbh heating capacity
- Optional 16:1 high turndown furnace

Remote Condenser

(Paired with Models RV-25, 45 and RVE-40, 85)

- 5 to 30 tons cooling capacity
- 800 to 8,500 cfm
- Hot gas reheat and compressors internally mounted and piped within the RV/RVE unit
- Low sound condenser fans
- Lead EC condenser fan



Product Certifications

Greenheck takes pride in offering a high quality, reliable product. We invest our resources into designing, testing and manufacturing products to ensure customer satisfaction.



ETL Listed for electrical and overall unit safety. Every unit is tested at the factory before it is shipped to the jobsite.



AHRI Certified coils and energy wheels. To guarantee your coil is going to perform as required, check for AHRI Certification.



Energy recovery wheels are certified by the AHRI Air-to-Air Energy Recovery Ventilation Equipment Certification Program in accordance with AHRI Standard 1060. Actual performance in packaged equipment may vary. Certified ratings are available in the Certified Product Directory at www.ahridirectory.org.

Energy Efficiency

Inverter Compressor

An inverter compressor option is available from 5 to 70 tons with packaged DX cooling. The inverter compressor provides many benefits.

- Improved part load efficiency
- Integrated Energy Efficiency Ratio (IEER) up to 22.1, with an average improvement over a digital scroll compressor by 15 to 20%
- Reduced sound levels
- Precise temperature and humidity control



High Turndown Furnace

A high turndown furnace option is available on models RV and RVE. This high turndown is industry-leading technology for the tubular-style heat exchanger market.

- Up to 16:1 turndown per furnace
- Precise temperature control
- Fully modulating control
- Less cycling during part-load conditions
- Commissioning sequence for easy start-up



Flexible and Cost Effective Configurations

Horizontal Duct Connections

An optional side or end return air intake and side discharge is available for installation flexibility. Common applications include indoor mounted, pad mounted, or rooftop mounted reducing ductwork, system effect, and eliminating the need for a tall, costly plenum curb.

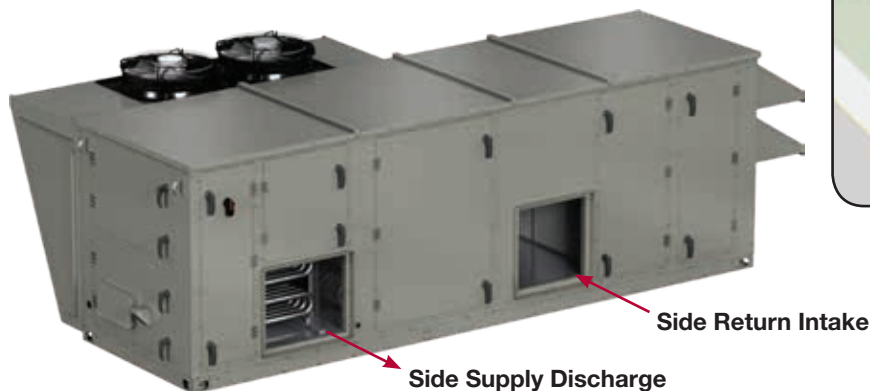

Simple, Easy Start-Up

Microprocessor

The models RV and RVE include a microprocessor controller that is factory programmed, wired and tested prior to shipment. The controller can operate stand-alone or integrate with a Building Management System (BMS) using BACnet® MS/TP or IP, LonWorks® or Modbus® RTU protocols. This controller is responsible for operating the unit in a safe and energy efficient manner while controlling temperature and humidity.



Built-in Furnace Commissioning Guide

Controller commissioning menus make for simple and easy start-up, saving time and money. See below for example of furnace start-up menus.

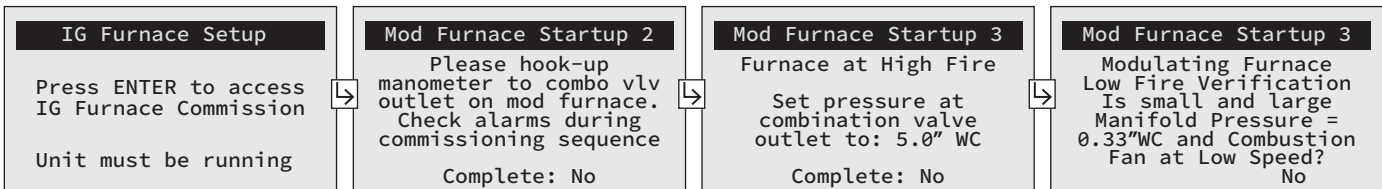

Web User Interface (UI)

Greenheck's microprocessor controller comes standard with a web user interface allowing the unit to be viewed and controlled from a web browser. With an Ethernet connection from the RV/RVE unit to the facilities network, a full graphic, specific to the unit selected, will allow for monitoring and control of the unit without a Building Management System (BMS). Other features include full control display access, customizable data trending, and service contact information.



Application Flexibility

Remote Condenser

Greenheck's optional remote condenser is available from 5 to 30 tons with models RV and RVE. Common remote condenser applications include standing seam (sloped) roofs, retrofits, restricted roof space, and restricted structural (load) limitations.

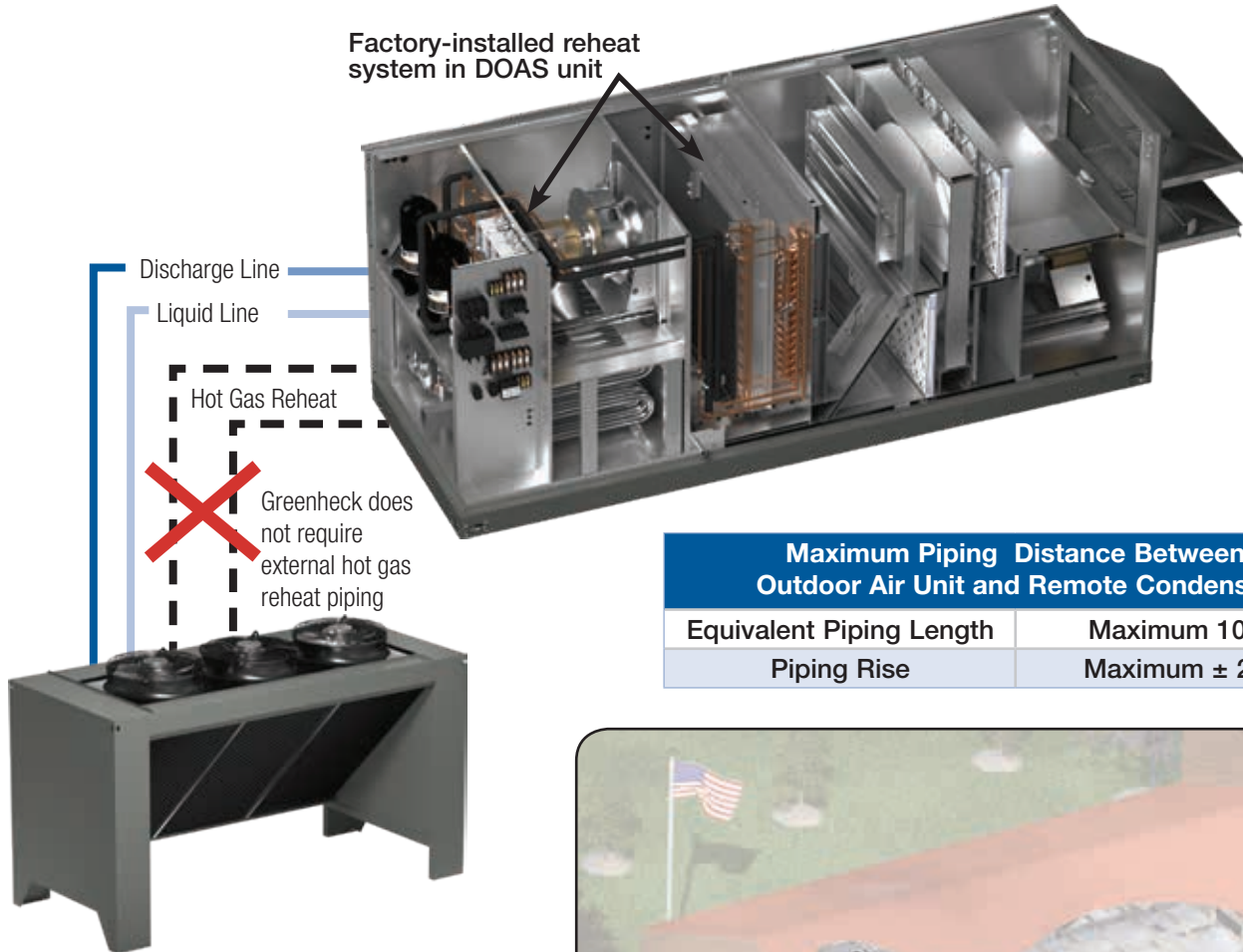

Maximum Piping Distance Between Outdoor Air Unit and Remote Condenser	
Equivalent Piping Length	Maximum 100 ft.
Piping Rise	Maximum ± 25 ft.



Feature	Benefit
Single-source manufacturer	Simplifies line sizing and controls
Complete system is factory tested prior to shipping	Provides confidence in overall system reliability
Hot gas reheat and compressors mounted within DOAS unit	Ensures proper installation of refrigeration components
Low sound condenser fans	Significantly reduces sound levels by up to 8 decibels
Electronically commutated (EC) motor on lead condenser fan	Increases part load reheat capacity and system efficiency
Indoor or outdoor mounting options	Allows for greater design flexibility of the DOAS unit

1 Plenum Supply/Exhaust Fan

- Direct drive backward-curved plenum fan
- Neoprene isolation
- Factory provided variable frequency drive

2 Construction

- 2-inch double-wall construction unit housing and base
- R13 foam insulation thermally broken
- Available finishes include:
 - Permator™ (2,500 hr/salt spray rating under ASTM B117 testing conditions)
 - Hi-Pro Polyester (5,000 hr/salt spray rating under ASTM B117 testing conditions)

3 Filters

- Outdoor air and exhaust filters (pre-wheel)
 - 2-inch MERV 8
 - 2-inch aluminum
- Supply filters (pre-coil)
 - 2-inch MERV 8 or MERV 13
 - 4-inch MERV 8 or MERV 14
 - Combination of MERV 8 and MERV 11, 13 or 14

4 Control Center

- 24 VAC control voltage
- Control transformer
- Non-fused disconnect switch
- UL Listed, Recognized, or Classified electrical components
- Factory prewired for single point power connection
- Phase and brownout protection (PDX)
- Optional exhaust fan only power

5 Weatherhood

- Aluminum mesh filters
- Wind-driven rain prevention

6 Total Energy Wheel (RVE)

- Sensible and latent energy recovery
- Lightweight, segmented wheel for easy cleaning
- L₁₀ rated bearing life in excess of 400,000 hours
- Permanently bonded, silica gel desiccant for latent transfer — long term durability
- Stainless steel housing

7 Cooling Options

- Packaged direct expansion (PDX)
 - Optional modulating head pressure control (EC motor or VFD on lead condenser fan)
- Chilled water coil
- Split DX coil with or without remote condenser
- All coils with copper tubes and permanently expanded aluminum fins
- Mounted on a stainless steel drain pan

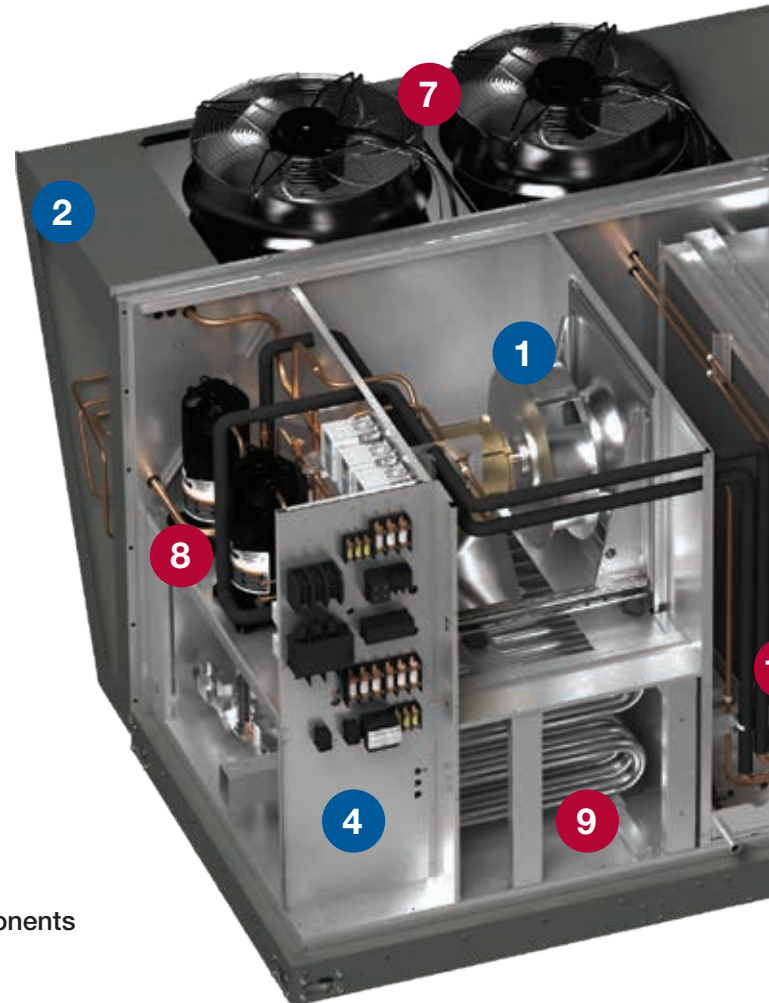

S Standard Feature **O** Optional Feature

8 Compressors

- Quiet operating hermetic, scroll-type
- 5 to 70 tons of mechanical cooling
- Optional compressor for lead circuit:
 - Standard scroll
 - Digital scroll
 - Inverter scroll (5 to 70 tons cooling capacity, PDX only)

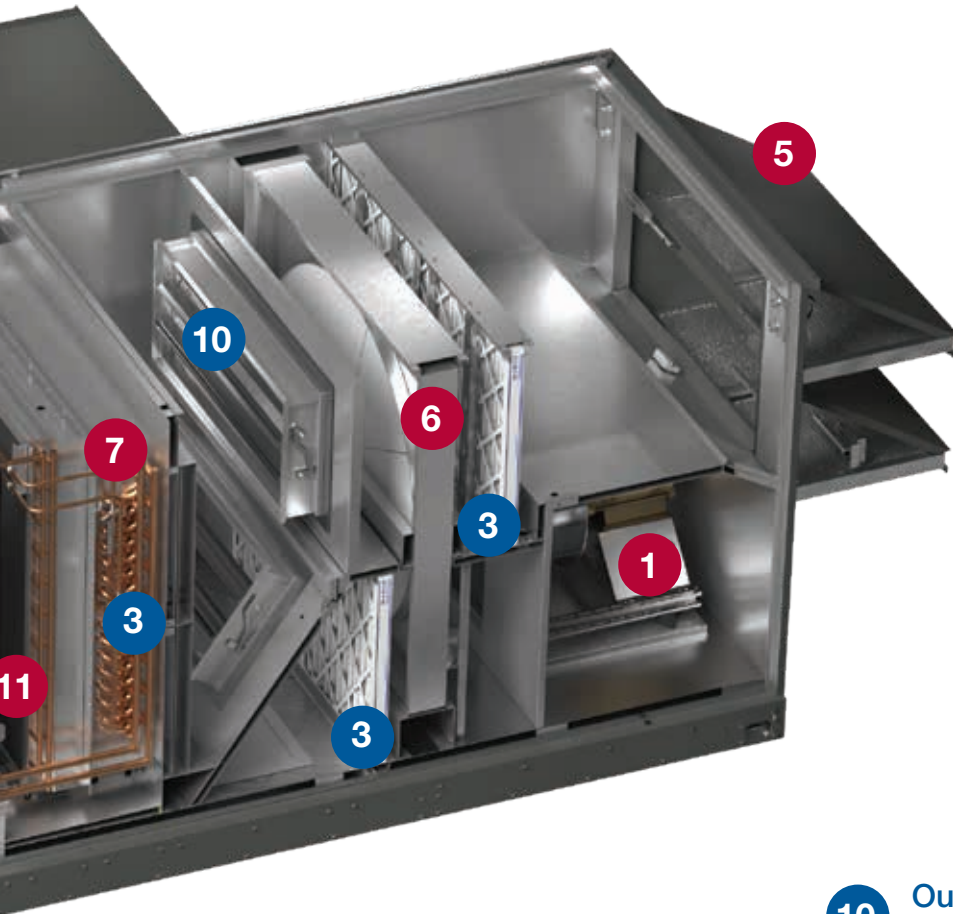

Optional Accessories

- Building Pressure Sensor
- CO₂ Sensor
- Condensate Overflow Switch
- Condenser Hail Guards
- Dirty Filter Sensor
- Duct Pressure Sensor
- Economizer Control
- Electrofin Coated Coils
- Energy Wheel Bypass Damper
- Microprocessor Remote Interface
- Outdoor/Exhaust Airflow Monitor
- Roof Curbs
- Room Temperature Sensor
- Combination Room Temperature and Humidity Sensor
- Room Thermostat
- Rotation Sensor
- Service Lights
- Service Receptacle
- Smoke Detectors
- Wheel Frost Controls

9 Heating Options

- Indirect gas-fired furnace
 - Optional high turndown furnace (up to 16:1) - *patent pending*
 - Optional stainless steel heat exchanger with optional 5 or 10 year extended warranty
- Electric heater
 - Silicon controlled rectifier (SCR) control
- Hot water coil

10 Outdoor Air and Recirculated Air Dampers

- Low leakage or insulated low leakage
- Modulating actuator

11 Reheat

- Modulating hot gas reheat
- 6 in. separation between DX and reheat coil components to prevent evaporation of condensate

Quietly Making an Impact

Greenheck offers a variety of solutions for sound critical applications allowing for unprecedented design flexibility.

- Low sound swept blade condenser fans
- 2-inch R13 foam unit and base
- Compressor isolation
- Tested radiated sound data

Greenheck's actual radiated sound data is tested in accordance with AMCA 320-07 in our state-of-the-art testing facility, the Robert C. Greenheck Innovation Center.

The low sound condenser fans paired with the radiated sound data of the unit operating at full load allows proper design with actual tested data. For example, if equipment is too loud or placed too closely to other buildings, corrective actions can be time consuming and costly. Greenheck provides low sound condenser fans as standard, offering an average sound power reduction of 5 to 8 decibels when compared to typical condenser fans.

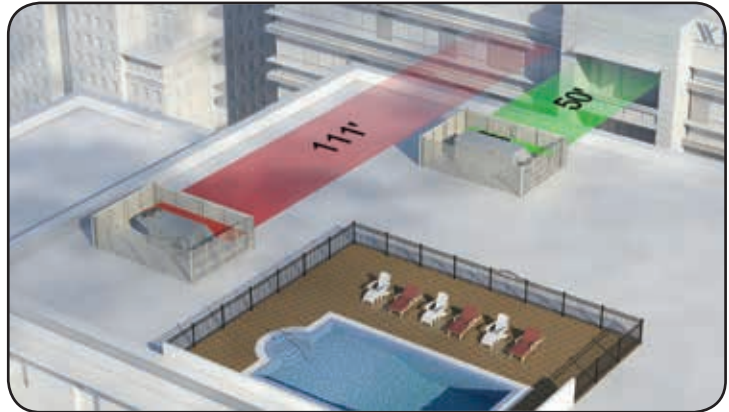

RADIATED SOUND LEVELS										
Plane	Octave Bands (Lw)								Plane Lw	Plane LwA
	1	2	3	4	5	6	7	8		
A	73	85	78	80	81	73	67	62	88	83
B	71	79	69	78	73	68	64	57	83	78
C	79	77	69	76	75	70	60	59	83	78
D	74	77	72	74	74	67	61	58	82	77
E	77	84	78	79	77	72	65	61	87	81
Total	83	89	82	85	84	78	71	67	93	87

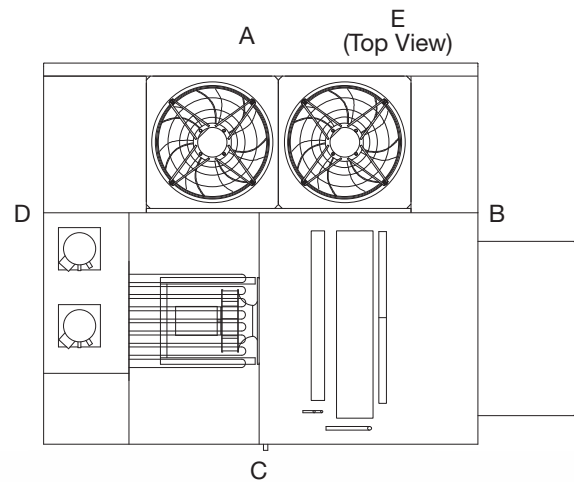

Tests conducted in accordance with AMCA 320-07 - Laboratory Methods of Sound Testing of Fans Using Sound Intensity.

Free field measurement plane created one foot from unit on all sides and top tested at max capacity.

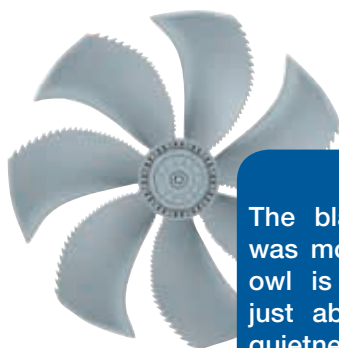

Did you know?

The blade shape of the low sound condenser fan was modeled from one of the best - nature! The barn owl is known for its quietness during flight to fly just above their prey, without being detected. That quietness is attributed to their specialized feathers featuring a serrated edge, very similar to the profile of the fan blades in our low sound condenser fans.



Web-Based Outdoor Air Selections

Greenheck's free, online eCAPS® Engineer Application Suite provides fast and easy selection of HVAC products including RV and RVE products. Go to ecaps.greenheck.com and see how this comprehensive specifying tool can save you time.

- Online and always up-to-date
- Fast and efficient selection
- Simplified Dedicated Outdoor Air System (DOAS) selection providing:
 - Weights
 - Capacities
 - Dimensional data
 - Revit content
 - Electrical data
 - Unit cut sheets
- Quick comparison of unit options with or without energy recovery
- Scheduling capabilities within minutes



Energy Recovery Model Comparison X				
	Without Energy Recovery		With Energy Recovery	
	RV-45-25	RVE-40-15	RVE-85-15	RVE-85-15
	Add	Add	Add	Add
Enthalpy Recovery Ratio (%)	-	52.6	58.4	64.0
Relative Price	1.00	0.92	0.97	1.00
Weight (lbs)	3,742	3,603	4,637	4,699
Dimensions (LxWxH) (in)	109 x 68 x 76	150 x 53 x 66	163 x 68 x 76	163 x 68 x 76
MCA/MCP (Amps)	129.0 / 175	86.9 / 110	81.8 / 100	81.8 / 100
Cooling LAT (F)	55.3 / 55.2	55.5 / 55.2	54.4 / 54.1	53.3 / 53.1
Cooling Dewpoint (F)	55.1	55.0	54.0	52.9
Total Cooling Capacity (MBH)	327	203	200	197
Heating LAT (F)	84	81	104	107
Heating Capacity (MBH)	320	160	240	240
Supply Volume (CFM)	4,000	4,000	4,000	4,000
Outdoor Volume (CFM)	4,000	4,000	4,000	4,000
Exhaust Volume (CFM)	-	3,000	3,000	3,000
				Close

Cost reduction with energy wheel! \$\$\$

10 ton reduction with energy wheel!

Allows you to choose your exhaust air volume.



Models RV-25, 45, 70 and Models RVE-40, 85, 120

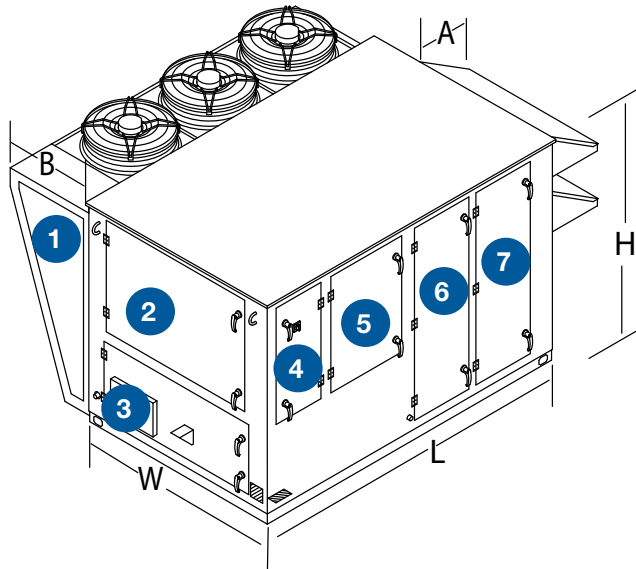

Models RV-110 and RVE-180

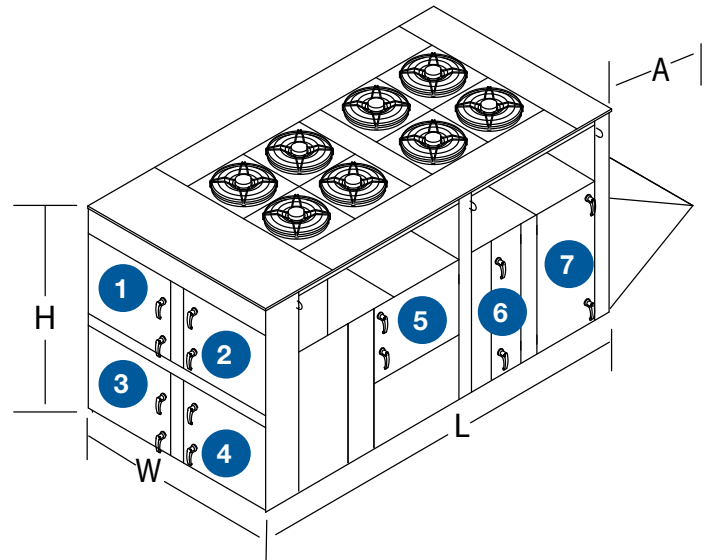

Component Access

1	Optional Inverter Drive	6	Coil
2	Optional Compressor/Electrical	7	Filters
3	Optional Gas Furnace/Optional Electric Heater	8	Wheel Access <i>(not shown)</i> <i>When RVE is selected, door 8 will be to the right of door 7.</i>
4	Electrical	9	Exhaust Blower/Optional Electric Preheat <i>(not shown)</i> <i>When a powered exhaust RV is selected, door 9 will be located to the right of door 7.</i>
5	Supply Blower		

Unit Size	Nominal tonnage (tons)	Height (H)	Width (W)	Length (L)	Intake (A)	Condensing Section (B)	Nominal weight (lbs)	Outdoor Intake	Supply Discharge	Return Intake	Exhaust Discharge
RV-25	5-15	59.3	52.5	98.6 ⁷ / 149.5 ¹	22.1	30.1	2,700	End	Bottom or Side	Bottom, End ² or Side ¹	End ³ or Side ¹
RV-45	15-30	72.5	68.2	109 ⁷ / 163.2 ¹	27.7	30.1	4,500				
RV-70	25-45	90	68	156 ⁷ / 224 ¹	22/27 ⁴	30	6,400				
RV-110	30-70	99.5	96	185	52.5	Not Applicable	7,950			Bottom or End	Side ¹
RVE-40	5-15	59.3	52.5	149.5 ⁶ / 180.5 ⁵	22.1	30.1	3,400	End	Bottom or Side	Bottom or Side	Side
RVE-85	15-30	72.5	68.2	163.2 ⁶ / 197.2 ⁵	27.1	30.1	5,100				
RVE-120	25-45	90	68	224 ⁶	22/27 ⁴	30	8,300			Bottom	
RVE-180	30-70	99.5	96	263 ⁶ / 307 ⁵	47	Not Applicable	10,450			Bottom or Side	

All dimensions are shown in inches. Weight is shown in pounds and includes largest supply and exhaust fans, PDX with reheat, largest indirect-gas fired furnace, all dampers and largest energy wheel. Actual weights will vary based on the unit configuration.

¹ Only available with powered exhaust

⁴ Above 12,000 cfm

⁷ Length with bottom or end return

² Only available without barometric relief

⁵ Length with side return

³ Only available with barometric relief

⁶ Length with bottom return

Model	Airflow (SCFM)
RV-25-5I-*	2325
RV-25-5D-*	2325
RV-25-5S-*	2325
RV-25-7.5I-*	2300
RV-25-7.5D-*	2300
RV-25-7.5S-*	2300
RV-25-10I-*	2700
RV-25-10D-*	2800
RV-25-10S-*	2800
RV-25-12.5I-*	3400
RV-25-12.5D-*	3550
RV-25-12.5S-*	3550
RV-25-15I-*	3775
RV-25-15D-*	3775
RV-25-15S-*	3775
RV-45-15I-*	4100
RV-45-15D-*	4100
RV-45-15S-*	4100
RV-45-17.5I-*	4650
RV-45-17.5D-*	4650
RV-45-17.5S-*	4650
RV-45-20I-*	4900
RV-45-20D-*	5100
RV-45-20S-*	5100
RV-45-25I-*	5750

Model	Airflow (SCFM)
RV-45-25D-*	5600
RV-45-25S-*	5600
RV-45-30I-*	6000
RV-45-30D-*	6000
RV-45-30S-*	5750
RV-70-25D-*	6500
RV-70-25S-*	6500
RV-70-30D-*	7000
RV-70-30S-*	7000
RV-70-35D-*	7000
RV-70-35S-*	7000
RV-70-43D-*	8100
RV-70-43S-*	8100
RV-110-30D-*	9000
RV-110-40D-*	10500
RV-110-50D-*	10500
RV-110-30I-*	9000
RV-110-40I-*	10500
RV-110-50I-*	10500
RVE-180-30D-*	9000
RVE-180-40D-*	10500
RVE-180-50D-*	10500
RVE-180-30I-*	9000
RVE-180-40I-*	10500
RVE-180-50I-*	10500

Full load rating airflow per AHRI 340/360

Model Number Code

The Model Number Code is designed to completely identify the unit. The correct code letters must be specified to designate the configurations and size.

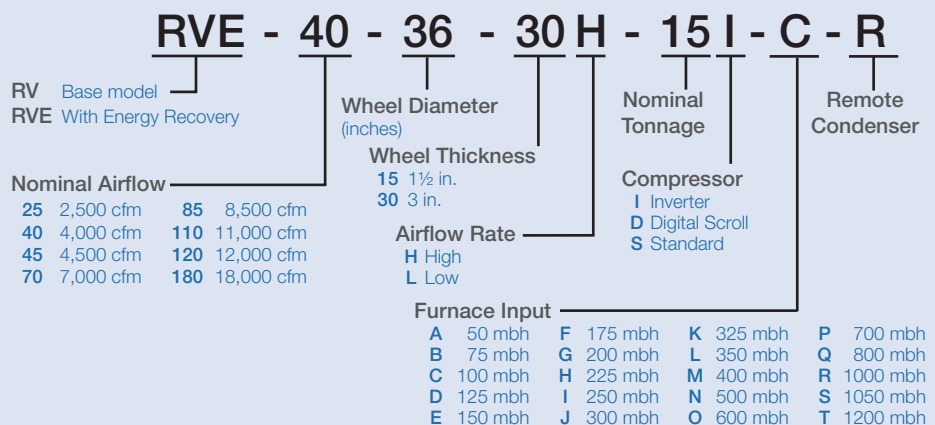

Challenge: Conditioning High Percentage Outdoor Air with Minimal Energy Usage

Solution



- High capacity (6-row) cooling coil
- 2-inch double-wall R13 foam construction
- (optional) Energy recovery wheel to precondition the outdoor air
- (optional) Modulating hot gas reheat coil
- (optional) Inverter compressor
- (optional) High turndown indirect gas-fired furnace
- (optional) Modulating head pressure control

Challenge: Controlling Outdoor Air Volume

Solution

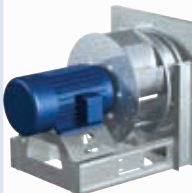

- Low leakage dampers with modulating actuator
- Factory mounted and wired microprocessor controller
- Energy efficient control sequences
- Direct drive backward-curved plenum fan with factory mounted VFD
- Remote monitor and control from web-user interface

Challenge: Critical Sound Applications

Solution



- Low sound condenser fans
- Radiated sound data off five planes of unit tested at full load
- 2-inch R-13 foam insulated unit base
- Compressor isolation
- (optional) Inverter scroll at part load
- (optional) Electronically commutated (EC) motor

Challenge: Finding a Manufacturer Dedicated to Outdoor Air

Solution



Models RV and RVE
5 to 70 tons
800 to 18,000 cfm



Our Commitment

As a result of our commitment to continuous improvement, Greenheck reserves the right to change specifications without notice.

Product warranties can be found online at Greenheck.com, either on the specific product page or in the literature section of the website at Greenheck.com/Resources/Library/Literature.

Greenheck P.O. Box 410 • Schofield, WI 54476-0410 • Phone (715) 359-6171 • greenheck.com

Copyright © 2019 Greenheck Fan Corp. • 00.TAP.1040 R9 7-2019



Prepared to Support
Green Building Efforts